

## Place the first finger joint to the white line on the device

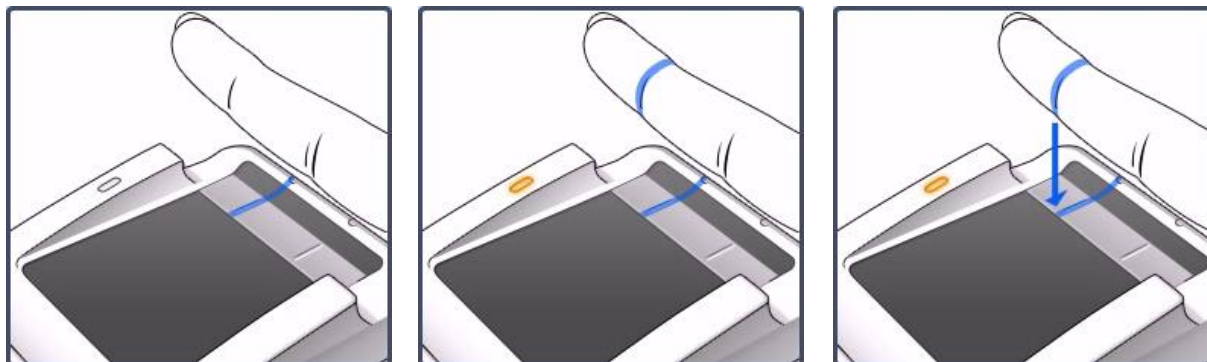

In case you have a device in hand



In case you use an optional stand



- For **FVA-U3SX** or **FVA-U2SXA**, gently place your finger on the device.
  - For **FVA-U2SX**, firmly place your finger on the device and hold for a moment, then rest your finger gently on the device.
- ※ If you are not sure which model you are using, please try the method for FVA-U2SX.

It is ideal to place a finger similarly both for enrollment and authentication. Being careful to follow the procedures above at enrollment and it would make any subsequent operations easy.